

**Bill of Quantities**  
**DUAL DESKS FOR VII TO X CLASSES TYPE-III**

Sl. NO	Est. Qty	Unit	SCHEDULE -	Description of Item	Type of item	Rate / One dual desk	Amount (Rs.)
1	2,10,000 Nos.	Each	<b>Supply &amp; Placing Dual desk for class VII to X ; TYPE - III</b>	<p>The overall dimensions of desk will be W 1066mm x D 930mm x H 760 (for table top). The seating bench height shall be <b>452 mm</b>. The desk shall be manufactured as per the specifications mentioned below: -</p> <ol style="list-style-type: none"> <li>1. Table top shall be made up of 18.0 mm thick plywood (tolerance as per IS 303) of MR Grade OSL (one side shall be laminated, and other side shall have balancer finish). Table top dimensions shall be W 1008.0 mm x D 380.0 mm. Edge towards bench shall be post formed with round edge. The remaining three edges must be sealed with 2mmthick PVC edge banding tape. Edge band must be trimmed on edges and corners. The desk shall be Greenguard certified for low chemical emission of VOCs (Voltage Organic Compounds) and carcinogens, contributing to a healthier room environment. Valid certificate to be submitted along with the bid. Make of Plywood : Merino / Greenply / Century / Kitply. Make of Laminate &amp; balancer : Marino / Greenlam / ASIS / Century.</li> <li>2. Side frame structure: Made of CRCA press-formed section 165.0 mm x 25.0 mm x 1.0 mm thickness bolted to 25.0 mm x 50.0 mm x 1.2mm thickness tube of 890mm length by using C-clamps made up of 3.0 mm thickness sheet. Make for CRCA sheet - ESSAR / TATA / SAIL / JINDAL. Proposed desk should be RoHS certified from Intertek/UL. Valid certificate to be submitted along with the bid.</li> <li>3. Seat and back rest frame structure: Made of CRCA press-</li> </ol>	<b>Dual Desk</b> <b>TYPE - III</b>	Rs.6895.00/-  (Rupees Six Thousand eight hundred and ninety five only)	Rs.144,79,50,000.00

Firm



Managing Director  
APEWIDC, Vijayawada

12/06/2000

M/12/6

12/6

formed section 165.0 mm x 25.0 mm x 1.0 mm thickness welded to MS pipe of 25.4 mm diameter x 1.2mm thickness. All 8 numbers of horizontal supports shall be made up MS tube having dimensions 25.0 mm x 25.0 mm x 1.2 mm thickness. MS tube of size 20.0 mm x 20.0 mm x 1.0 mm thickness and 100.0 mm long shall be welded to the frame to hold the horizontal supports. Raw materials of MS tubes shall be from ESSAR / TATA / SAIL / JINDAL.

4. Rectangular MS tube of dimension 50.0 mm x 25.0 mm x 1.2 mm thickness shall be closed with PPCP (Polypropylene Copolymer) cap at both the ends. Pipe diameter 25.4 mm x 1.2 mm thickness shall be closed with PPCP cap at back side and under the seat.

5. Upper modesty panel and shelf shall be made of 0.8 mm thick CRCA sheet. The dimensions for upper modesty panel shall be H 175.0 mm x W 1012.0 mm x D 23.0 mm. The dimensions of shelf shall be W 1012.0 mm X D 300.0 mm X H 23.0 mm. The shelf shall have vertical partition at the center. This partition shall be made up of square MS tube having size 25.0 mm x 25.0 mm x 1.2 mm thickness. Stiffeners of MS tube having sizes as 20.0 mm x 20.0 mm x 1.0 mm thickness shall be provided in upper modesty panel and shelf. Front fascia of upper modesty panel of desk shall have embossed design. The corners of shelf (projecting towards the seating bench) shall be rounded through corner-forming technology (without welding) to avoid injury in case of accidental impact.

6. Additional lower modesty panel having size H 150.0 mm x W 1008.0 mm X D 23.0 mm shall be made up of 0.8 mm thick CRCA sheet with designer square perforations. MS tube of size 20.0 mm x 20.0 mm x 1.2 mm thickness shall be fixed across the length at the bottom side of lower modesty panel.

7. Seat and back rest shall be made of 18mm thick plywood of

APEWIDC  
Managing Director



*[Signature]*  
Managing Director  
APEWIDC, Vijayawada

*[Handwritten notes and signatures]*

MR Grade OSL (one side shall be laminated, and other side shall have balancer finish) except back rest. Back rest shall have both sides lamination.

Technical details of seat and back rest are mentioned below:

7.1 Seating bench dimensions shall be W 1066.0 mm X D 300.0 mm: Front side shall be rounded with post forming. Remaining three edges shall be sealed with 2mm thick PVC edge banding tape.

7.2 Back rest dimensions shall be W 1066.0 mm x D 250.0 mm: Upper side shall be rounded with post forming. Remaining three edges shall be sealed with 2mm thick PVC edge banding tape.

7.3 Leg space between top and seat shall be 150mm.

8. Bag/bottle hooks shall be made of MS wire having diameter of 5.0 mm. The overall size of hook shall be W 23.0 mm, D 32.0 mm and H 80.0 mm. It shall be welded on inner facia of both the vertical press-fitted steel sections.

9. The MIG / Spot welding shall be done as per technical requirement.

10. All metal components shall be powder coated in satin finish with pretreatment process. Powder coating shall be tested and certified on following parameters from NABL Accredited/ Government Laboratory, Valid certificates / test reports to be submitted along with the bid.

10.1 Adhesion test: EN ISO 2409 (2 mm).

10.2 Impact resistance test: ASTM D 2794 (5/9' ball) on applying

180 kg of impact load.

10.3 1000 hrs. humidity test as per ISO 6270.

10.4 Salt spray (FOG) test: 1000 hours as per ASTM B 117.

10.5 Cross Hatch Adhesion test as per ASTM: D3359.

10.6 Conical Mandrel Test as per ASTM: D522.



M  
12/6

SR  
12/10/2020

10.7 Scratch Test as per IS:101-1964 by applying 2 kg load.  
**The item shall carry a warranty period of 5 (Five) years from the date of completion of supply & fixing.**

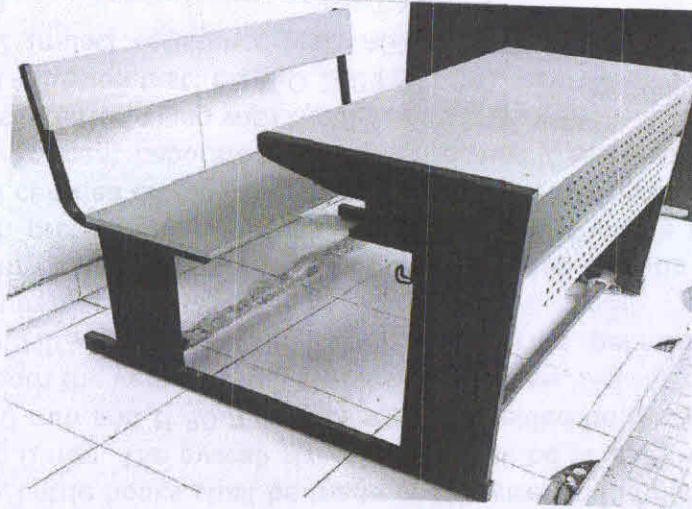

*R*  
12/06/2000

*H*  
12/6/00

*MS*  
12/6

*Sal*  
Managing Director  
APEWIDC, Vijayawada

# DUAL DESK -VII TO X CLASS

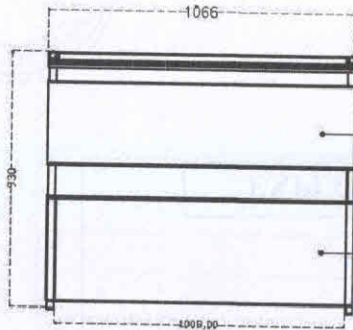

TOP VIEW

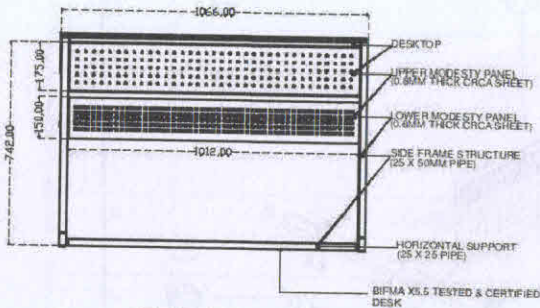

FRONT VIEW

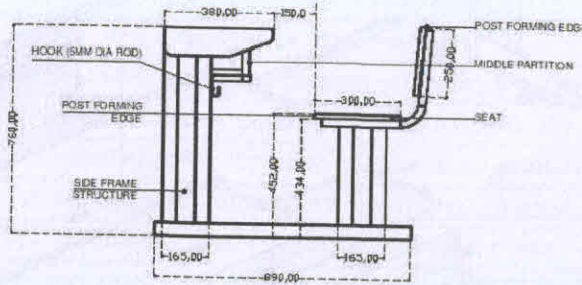

SIDE VIEW

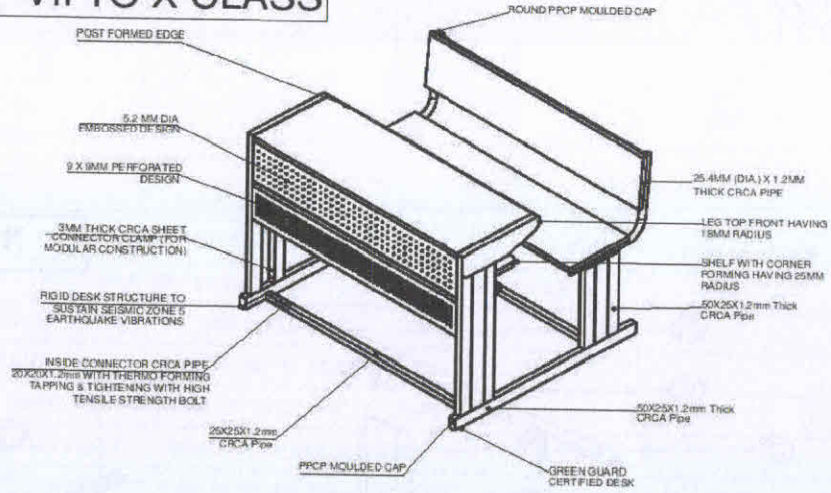

POWDER COATING TESTED & CERTIFIED AS PER BELOW PARAMETERS:

S.NO	PARAMETERS
1	ADHESION TEST AS PER ISO 12934
2	IMPACT RESISTANCE TEST AS PER ISO 15015
3	1000 HOURS HUMIDITY TEST AS PER ISO 9000
4	SALT SPRAY TEST - 4000 HOURS AS PER ISO 9000
5	CROSS HATCH ADHESION TEST AS PER ISO 2409
6	CONICAL HARDNESS TEST AS PER ISO 15005
7	SCRATCH TEST AS PER ISO 15704 BY #Pencil No Load
8	POWDER COATING TESTED & CERTIFIED AS PER BELOW PARAMETERS



12/06/2020

M  
12/6/2020

NO  
1216

*(Signature)*  
Managing Director  
APEWIDC, Vijayawada

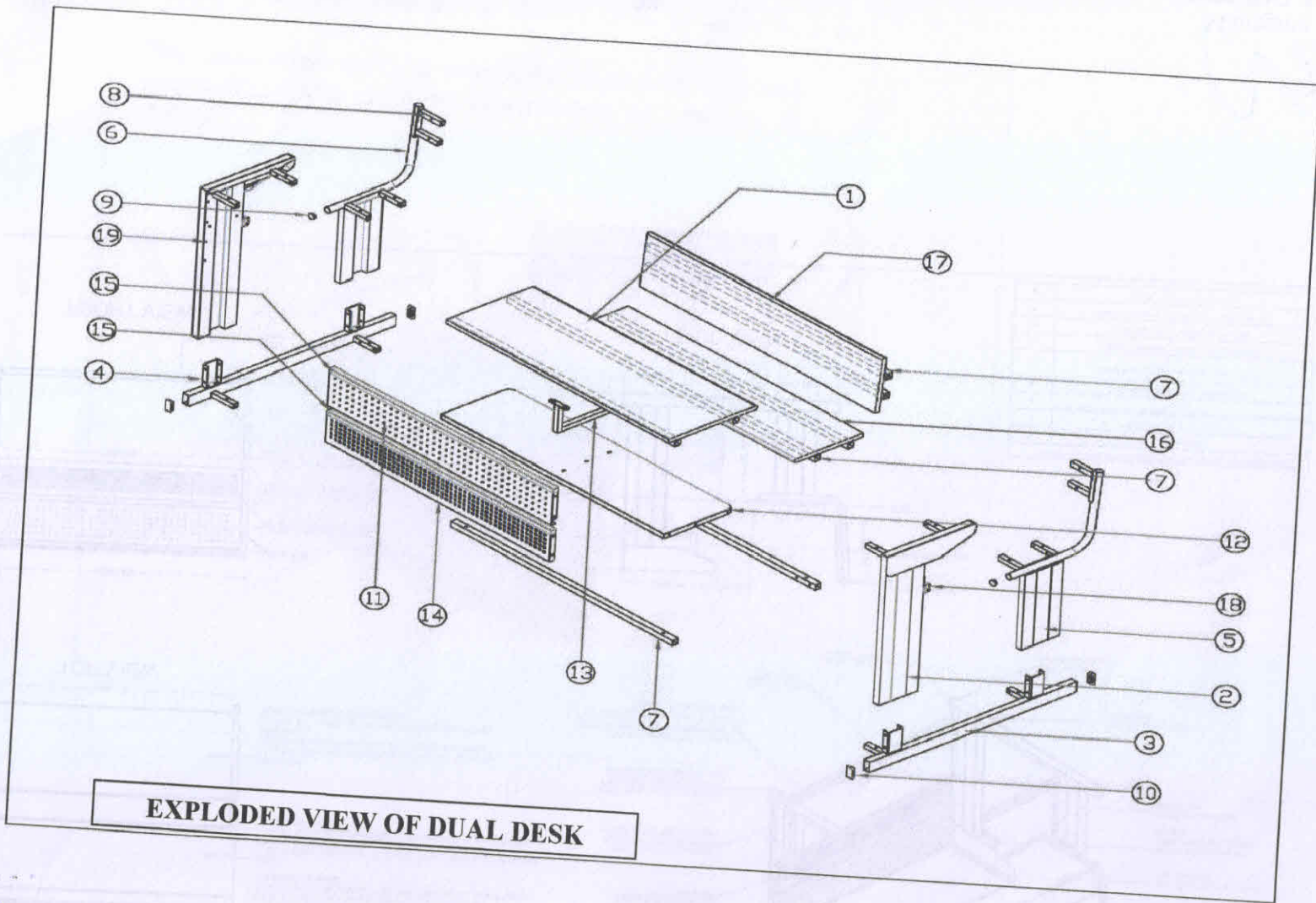

**EXPLODED VIEW OF DUAL DESK**



12/06/2011

12/6/20

ND  
2/6

*Bale*  
Managing Director  
APEWIDC, Vijayawada

PART NO.	PART DETAIL
1	TABLE TOP WITH ONE SIDE POST FORMED EDGE - 1008MM X 380MM
2	SIDE FRAME STRUCTURE MADE UP OF CRCA PRESS FORMED SECTION & 50X25MM PIPE VIA WELDING - 165MM X 25MM
3	Ø90MM LONG MS TUBE WITH PPCP CAP ON BOTH ENDS - 25MM X 50MM X 1.2MM
4	3MM THICK C-CLAMP FOR MODULAR CONSTRUCTION WELDED ON Ø90MM LONG MS TUBE
5	SEAT & BACK REST FRAME STRUCTURE - 165MM X 25MM
6	ROUND PIPE WELDED ON SEAT & BACK REST FRAME STRUCTURE - 25.4MM DIAMETER X 1.2MM
7	HORIZONTAL SUPPORT - 25MM X 25 MM X 1.2MM
8	100MM LONG MS TUBE WELDED ON FRAME STRUCTURE FOR HORIZONTAL SUPPORT - 20MM X 20MM X 1.2MM
9	PPCP CAP FOR 25.4MM DIA. ROUND PIPE
10	PPCP CAP FOR 50MM X 25MM MS TUBE
11	UPPER MODESTY PANEL WITH EMBOSSED DESIGN - 1012MM X 175MM X 23MM
12	SHELF WITH ROUND CORNERS (FRONT-SIDE) THROUGH CORNER FORMING TECHNOLOGY - 1012MM X 300MM X 23MM
13	VERTICAL PARTITION MADE UP OF 25MM X 25MM X 1.2MM MS TUBES
14	LOWER MODESTY PANEL WITH DESIGNER SQUARE PERFORATIONS - 1008MM X 150MM X 23MM
15	STIFFENERS OF MS TUBE WELDED ON SHELF, UPPER & LOWER MODESTY PANEL - 20MM X 20MM X 1.2MM
16	SEAT WITH ONE SIDE POST FORMED EDGE - 1066MM X 300MM
17	BACK REST WITH ONE SIDE POST FORMED EDGE - 1066MM X 250MM
18	BAG/BOTTLE HOOKS MADE UP OF 5MM DIA MS WIRE WELDED ON INNER SIDE OF THE FRAME STRUCTURE - 23MM X 32MM X 80MM
19	THERMO FORMING HOLE WITH TAPPING



  
 Managing Director  
 APEWIDC, Vijayawada

  
 12/6/2020

  
 12/6/2020

  
 12/6